

© Crown Copyright. Produced by HM Land Registry. Reproduction in whole or in part is prohibited without the prior written permission of Ordnance Survey. Licence Number 100026316.
See supplementary plan no. 1.
The land tinted green is not included in this title.

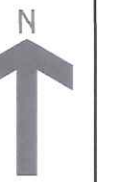

FOR LEASES SEE SUPPLEMENTARY PLAN

SEE SUPPLEMENTARY PLAN FOR LEASES

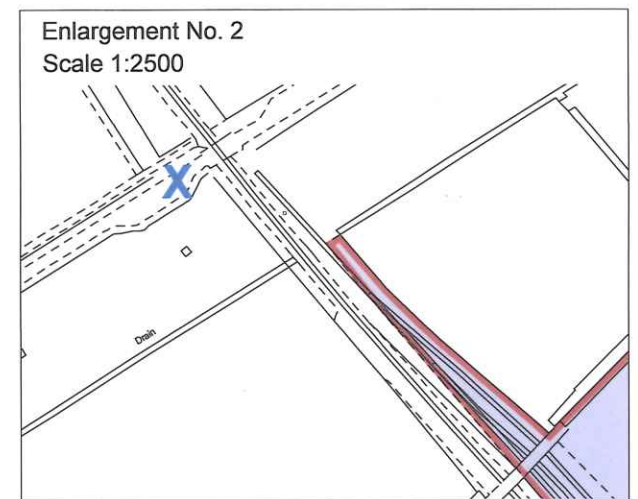
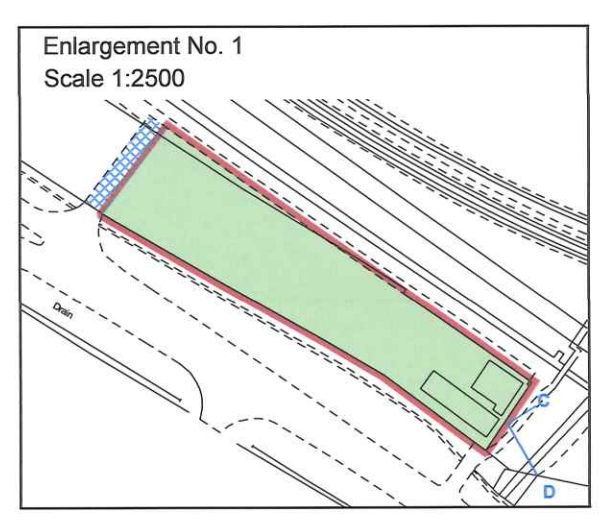
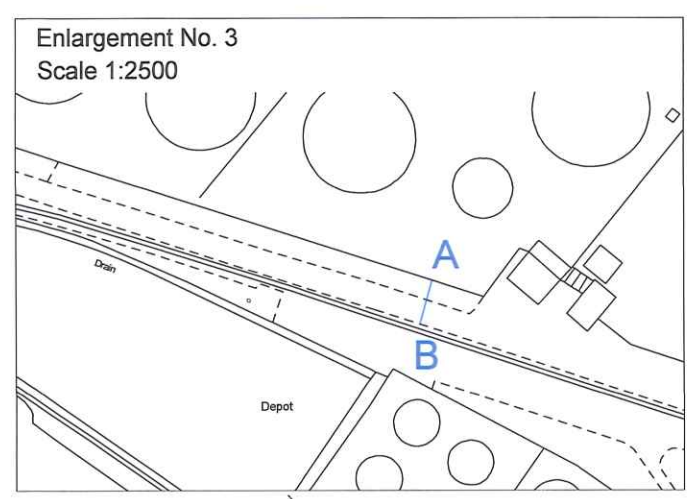
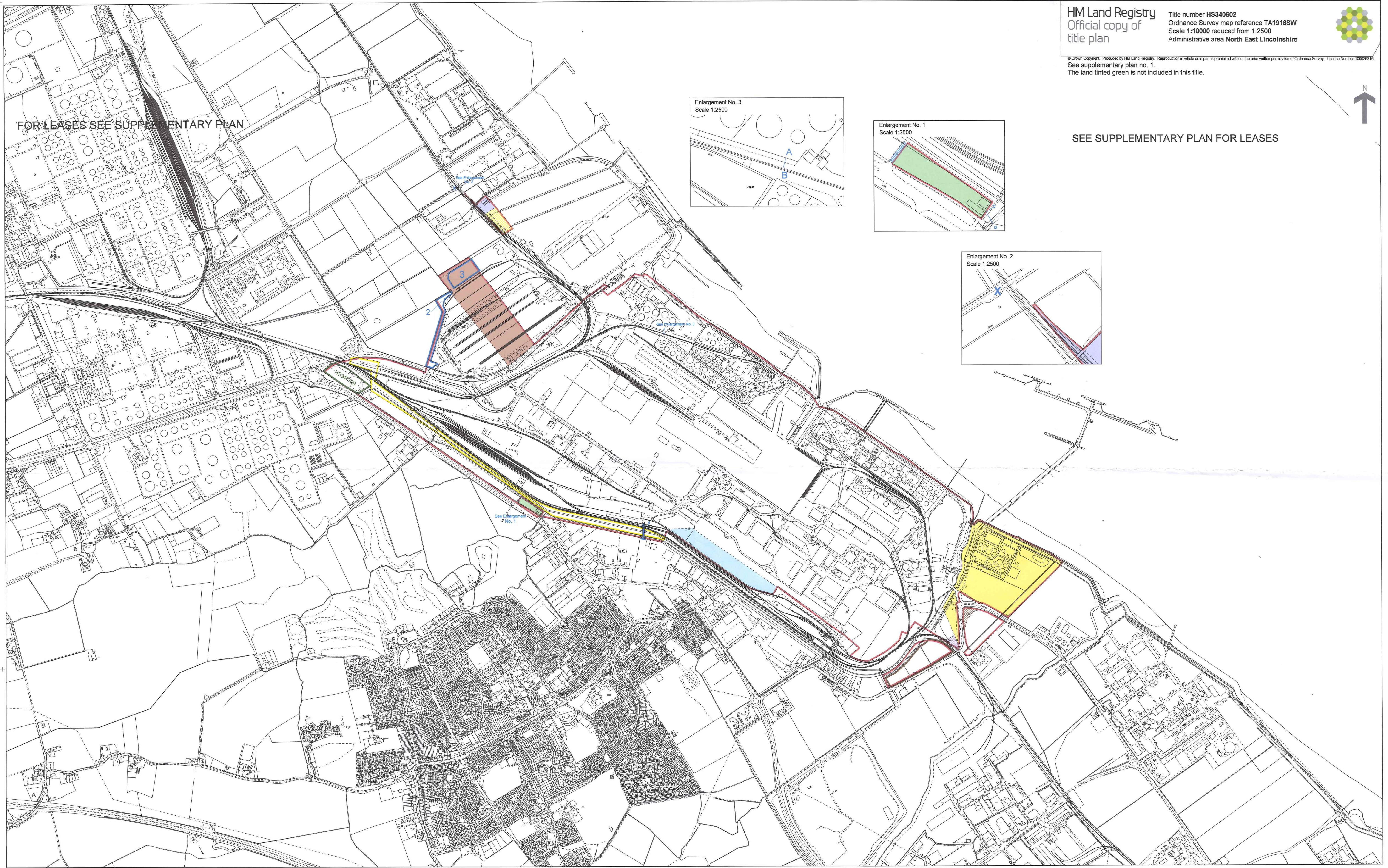

This official copy issued on 20 October 2023 shows the state of this title plan on 18 October 2021 at 08:31:47.
It is admissible in evidence to the same extent as the original (s.67 Land Registration Act 2002).
This title plan shows the general position, not the exact line, of the boundaries. It may be subject to distortions in scale. Measurements scaled from this plan may not match measurements between the same points on the ground.
This title is dealt with by HM Land Registry, Durham Office.